



PRODUCT CHANGE NOTIFICATION

MAGNETICS



Bourns® Model SRF0703 Series Dual-Winding Shielded Power Inductors

Mounting Base and Shield Design Change

Riverside, California – January 26, 2021 – Effective July 22, 2021, Bourns is changing the [SRF0703](#) series inductor mounting base and shield design to help prevent potential wire interference with terminal pins during assembly. Details of the changes are described below. A list of affected part numbers is available on the last page.

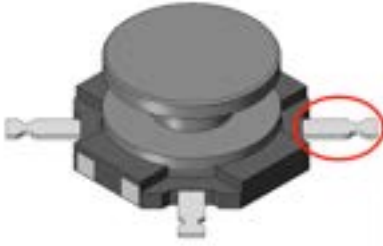
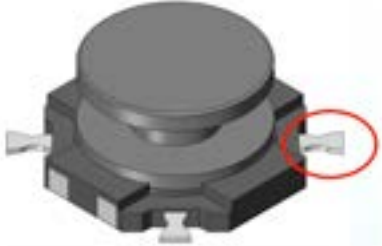
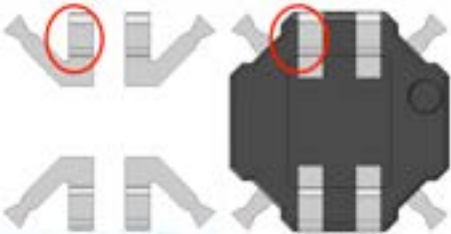
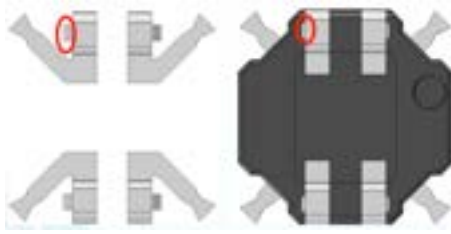
Current Mounting Base	Revised Mounting Base
 Long terminal pin	 Shorter terminal pin
 No terminal anchor	 Terminal anchor embedded in mounting base to increase terminal stability

Users should verify that the described changes will not impact the performance of the product in their specific applications.

IC209919

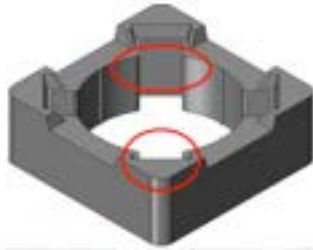
Current Shield

No wire channels

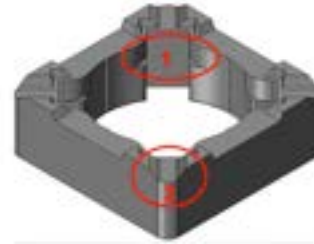
Revised Shield

- 1) Redesigned four corner channels to increase assembly space
- 2) Added four wire-channels

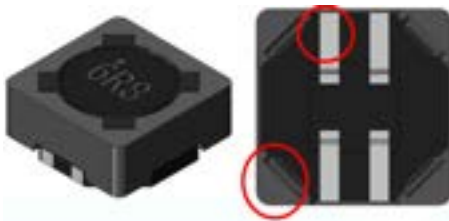
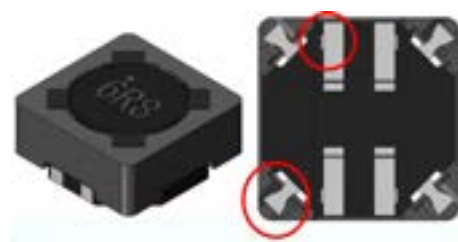
Current Appearance of Full Assembly**Revised Appearance of Full Assembly**

The form of the redesigned shielded power inductor will change. The fit and function will remain unchanged. The reliability and quality of the redesigned shielded power inductor should be improved as a result of the mounting base and shield redesign. Samples are available upon request.

Implementation dates are as follows:

Date that manufacturing of existing products will cease: **July 21, 2021**

Date that deliveries of modified products will begin: **July 22, 2021**

First date code using the above changes: **2129**

If you have any questions or need additional information, please feel free to contact [Customer Service/Inside Sales](#).

A list of affected part numbers is shown below.

Affected Part Numbers		
SRF0703-100M	SRF0703-2R2M	SRF0703-681M
SRF0703-101M	SRF0703-330M	SRF0703-6R8M
SRF0703-102M	SRF0703-331M	SRF0703-820M
SRF0703-150M	SRF0703-3R3M	SRF0703-821M
SRF0703-151M	SRF0703-470M	SRF0703-821MB
SRF0703-1R0M	SRF0703-471M	SRF0703-8R2M
SRF0703-1R5M	SRF0703-471MB	SRF0703-R33M
SRF0703-220M	SRF0703-4R7M	
SRF0703-221M	SRF0703-680M	